



# UNIVERSITY OF TORONTO ROTMAN SCHOOL OF MANAGEMENT

TORONTO, ON



## QUICK FACTS

- + Nine-storey addition to existing business school
- + Four-storey atrium
- + Integration with Heritage Building
- + \$65.6-Million Budget
- + 167,000 square feet
- + LEED Gold
- + Smith + Andersen mechanical, electrical, lighting, communications

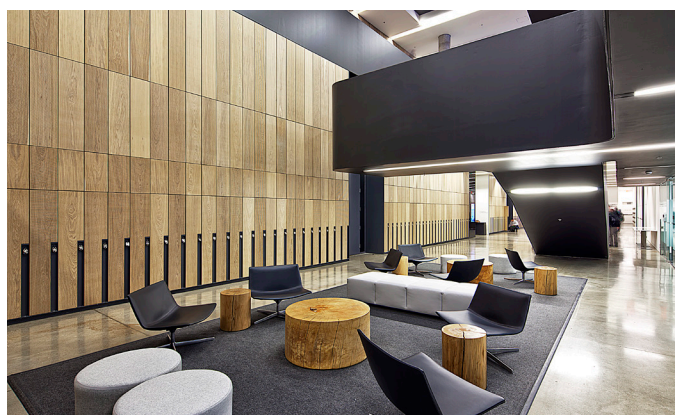
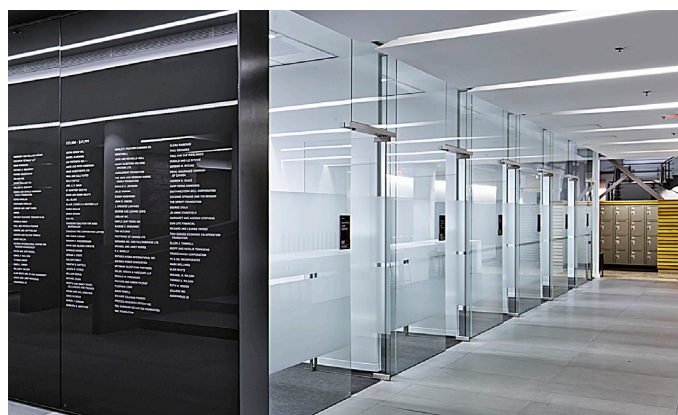
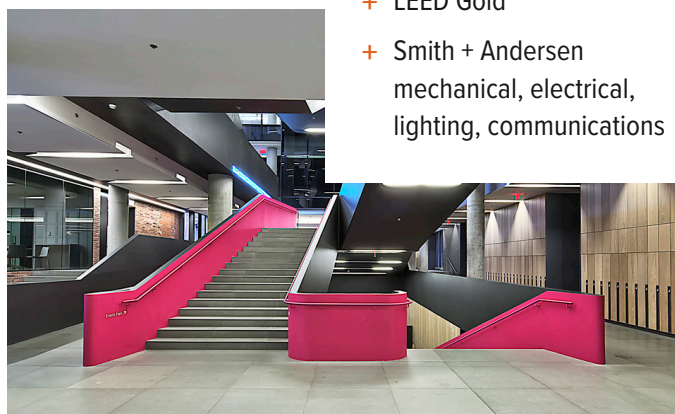



# UNIVERSITY OF TORONTO ROTMAN SCHOOL OF MANAGEMENT

## ABOUT THIS PROJECT

- + Nine-storey addition to the south end of the existing business school, connecting the landmark to the new building through a four-storey atrium. A feature stairway weaves through the atrium space.
- + Classrooms, student common areas, a full service cafeteria, and a 300 person event space occupy the bottom five floors of the building, while offices and meeting rooms make up the top floors.
- + During design, our team leveraged BIM to internally test the mechanical design for clash detection and to verify installation in mechanical rooms / congested ceilings.
- + Mechanical design included careful integration of the existing five-storey business school and heritage building, a complex hybrid smoke control system for the atrium, and the implementation of various noise / vibration mitigation strategies.
- + Electrical systems were designed with maximum flexibility for current users and spare capacity for future growth.
- + The telecommunications infrastructure, comprising a Category 6 horizontal and 10 Gigabit Ethernet backbone, serves as the information highway for systems such as building automation, security cameras, wayfinding, and an advanced audio-visual presentation and display system for classrooms and common areas.
- + Linear luminaires are strategically placed in the main staircase to overcome and illuminate the juxtaposition between black and hot-pink finishes.

## HOT BUTTONS

POST-SECONDARY

BIM (REVIT)

BAS

HERITAGE

LEED GOLD

LIGHTING DESIGN

NEW BUILDING

SUSTAINABLE DESIGN

### LOCATION

Toronto, ON

### SMITH + ANDERSEN SERVICES PROVIDED

Mechanical, Electrical,  
Lighting, Communications

### KEY TEAM MEMBERS

KPMB Architects

### SIZE

167,000 sq. ft. (15,511 sq. m.)

### BUDGET

\$65.6 Million

### COMPLETION YEAR

2012

### SUSTAINABILITY

LEED Gold

### AWARDS

IES Illumination Awards,  
*International Award of Merit* (2013)

IES Illumination Awards,  
*Toronto Section Award* (2013)

Ontario Architects Association,  
*Design Excellence Award* (2013)

